

LALIZAS 

Simply life saving

INFLATABLE LIFERAFT



LEISURE-RAFT

OWNER'S MANUAL
&
LOG BOOK

www.lalizas.com

Contents

1. Safety Precautions
2. Introduction
3. Description of the Liferaft
4. Instructions for use of the Liferaft
5. Equipment of the liferaft
6. Advice on the transportation and the storage of the liferaft
7. Advice on maintenance and servicing of the liferaft
8. Immediate Action Card
9. Log Book

1. Safety Precautions

- The LALIZAS Leisure-Raft is designed for use in emergency only.
- Do not expose liferaft to heat or flame. Contains compressed CO₂ gas cylinder.
- To avoid injury, stay away from the liferaft while it inflates.
- Read owner's manual before use.
- Do not use it in temperatures not recommended.
- Do not inflate liferaft for test or practice unless it's an emergency. Inflation without reason may cause damage to the fabrics and other components of the liferaft. Furthermore, it may damage the valise fabric.
- Do not repack the liferaft on your own. It is designed to fold and fit the valise in a certain way. Only authorized service stations should repack and inspect the LALIZAS Leisure-Raft.
- LALIZAS Leisure-Raft does not comply with any ISO, SOLAS or USCG regulations.
- Always wear an approved by local authorities Personal Flotation Device.

2. Introduction

This manual applies to the LALIZAS Inflatable Liferaft series Leisure-Raft. The LALIZAS Leisure-Rafts are available in the following types:

LALIZAS Product Code	Specifications
72200	4 persons with canopy
72201	4 persons without canopy
72202	6 persons with canopy
72203	6 persons without canopy

3. Description of the Liferaft

The liferaft has an Operating Temperature of 0 °C to +50 °C and a stowage/drop height of maximum 4m above the sea-level.

The liferaft is packed in a valise which can be stored in an internal locker as well. **The liferaft container is manufactured by materials that are resistant to exposure of bad weather.**

The liferaft can be up-righted in case of it being capsized and it is able to withstand the number of the persons it is designed to accommodate when it floats. It automatically inflates by pulling the painter line and retains its normal condition when it is loaded with all the persons and the equipment. Its floor is manufactured by waterproof materials.

The main body of the liferaft consists of one buoyant compartment (containing safety valve) manufactured by Nylon TPU coated. It is inflated through a non-return valve, ensuring the flotation of the liferaft. In case the buoyancy chamber is damaged, the pump, that is included in the standard equipment of the Liferaft, can be used for restoring the pressure.

The canopy of the liferaft (for the models with canopy) which is of vivid color is designed to protect the persons in the liferaft against bad weather conditions. It bears one entrance that is easily indicated and allows the flow of sufficient air for the persons onboard (even when it is closed).

The inflation system of the liferaft provides enough CO₂ gas to inflate the buoyancy chamber and bears a non return valve activated by an operating head that is driven by the painter line.

For all models of the Leisure-Raft, gas cylinder used for inflation is refillable. To maintain the good operation of gas cylinder, it must be inspected periodically by a LALIZAS authorized service station.



Picture 1. Valise of the liferaft

In the below Diagram of the LALIZAS Leisure-Raft the location of the Liferaft fittings are included:

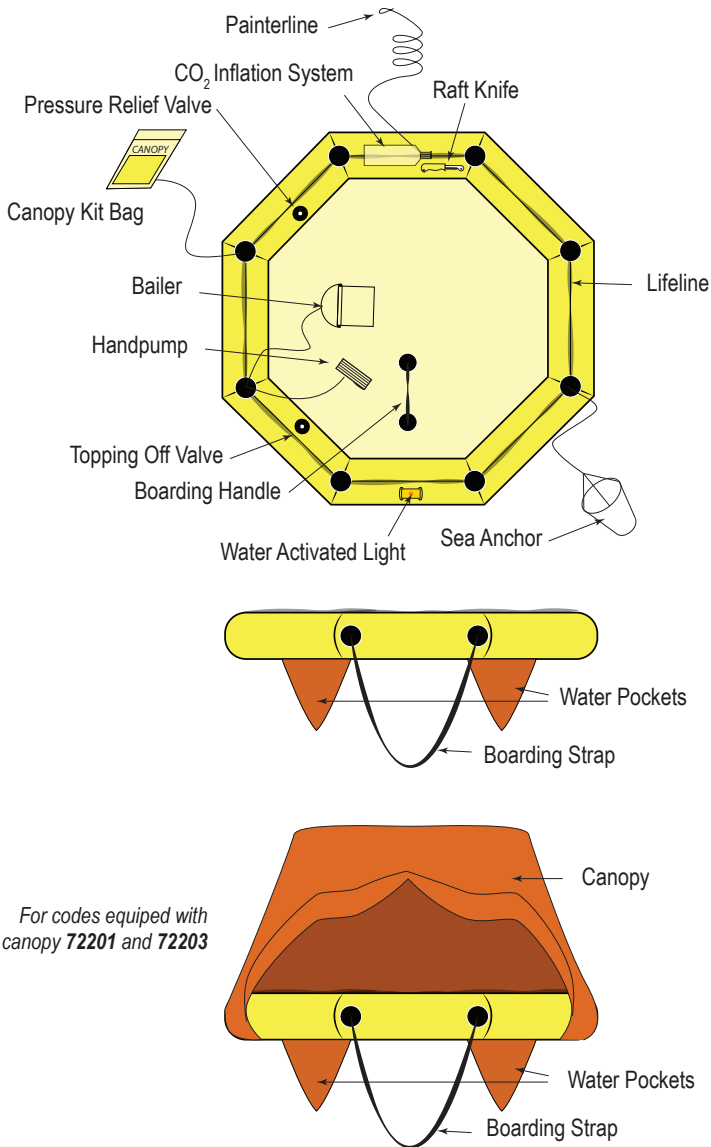

For codes equipped with canopy 72201 and 72203

Picture 2. Basic Construct of the Liferaft

Table 1: Fittings of the Liferaft

FITTINGS	
Painter line (6m)	The portion of it coming out of the container is light resistant.
External lifelines	Proper for being grasped, they don't slide from hands.
Righting device	Used by one person in order to right the liferaft when capsized.
Sea anchor (10m line)	Connected to the liferaft by a 10 meters long line.
Safety knife	In the side of the inlet gas cylinder valve, to the connection of the painter to the raft. Connected to the liferaft by a line of a suitable length. Buoyant, with fixed blade, rounded tips (so no damage is created to the liferaft in any case)
External light	It turns on automatically when it comes in contact with water.

4. Instructions for use of the Liferaft

Inflation of the liferaft

When the time to use the liferaft comes, first of all you should send alarms and signals by all means and put on lifejackets or other protective appliances on board. You should also remember to carry emergency position indicator (EPIRB) , GPS, fresh water and food as much as possible.

Move the liferaft from the stowage position to an open place on the deck of the boat.

Take out the painter line marked fabric cover valise and pull out approximately 2 meters of painter line. Attach the painter line to a solid point on the deck of the boat (Picture 3) to secure the liferaft.

Take the valise and throw it into the water (Picture 4). The valise of the liferaft will float.

During the time of the valise falling into the water, the painter line will be pulled out continuously. When the valise arrives at the water surface, the strong pulling out of painter line shall go on immediately (Picture 5) , until the release cable connected to the painter line activates the operation head of the gas cylinder.

NEVER OPEN THE PACKAGE

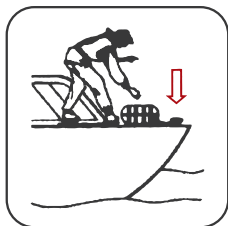

Picture 3

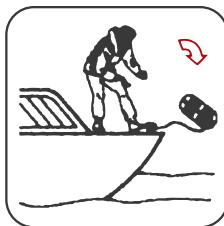

Picture 4

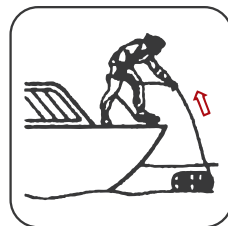

Picture 5

The gas cylinder then will inflate the buoyancy tube of the liferaft to its full shape and the liferaft will float on the water surface. After the inflation, a small normal leakage may occur in order to stabilize the pressure of the chamber. If the liferaft is in upward-floating position after it is fully inflated, pull the painter line to draw the liferaft close to the ship. If the liferaft is in reversed position after it is fully inflated, one person shall right it over to upward-floating position in the following way:

The operator shall grab with one hand the side which is equipped with the gas cylinder, pull the righting handle and turn it over about the cylinder. It will be easier under condition of downwind.

If the passenger's position is not far away from the water surface, he or she can jump into the liferaft directly. The passengers fallen into the water shall swim close to the liferaft, and then board the liferaft through boarding strap after they have taken off shoes and sharp objects.

After all the passengers have boarded the liferaft, separate the liferaft from the ship quickly by cutting off the painter line. Check the position of the safety knife in the diagram of the liferaft (see Picture 2).

After boarding, except seating orderly, the occupants shall search any others in the water and help them to board the liferaft by giving priority to the injured ones. Any fainted persons in the water must be put on board after been carried with their back close to the tube and lifted from armpits. All the persons that are onboard shall be as dry and heated as possible.

When the liferaft is away from the abandoned ship and in a safe position, after checking that the sea anchor is connected to the Liferaft properly, unroll it and launch it so as to avoid liferaft floating too far away from the sinking ship for the sake of rescuing in time.

Maintain the liferaft in a good condition.

Installation of the Canopy

For the models equipped with canopy follow the instructions below to install the canopy.

- Find the canopy bag and open it.
- Inflate the canopy arch using the red oral tube.
- When done with inflation, assemble the canopy arch with the buoyancy chamber using the buckles at the ends of the arch.
- Find the hook & loop tape on the inside of the canopy fabric and match them with the hook & loop tape on the Canopy arch.
- Pull the orange fabric down and hook the clips in the D-rings on the buoyancy tube.
- Lift the canopy till it is vertical to the floor.
- Place the bottom of the canopy outside of the liferaft.
- In order to ensure protection from physical elements keep the canopy down and closed.

Procedure is described in pictures below:

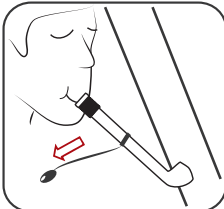

Inflate the canopy arch using the red oral tube

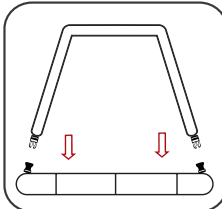

Assemble the canopy arch using the buckles

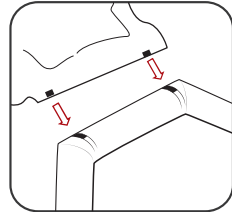

Match the Velcros of canopy and canopy arch

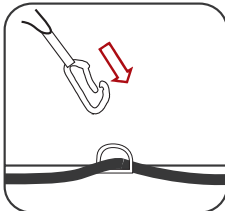

Clip the canopy on the D-rings

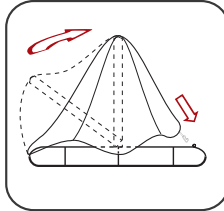

Lift the canopy arch

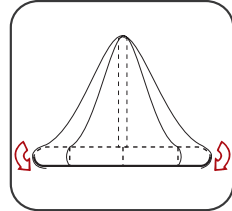

Place the canopy outside of the buoyancy tube

Sea Anchor

When boarded on the liferaft, throw the sea anchor to the sea in order to prevent liferaft from drifting.

5. Equipment and fittings of the liferaft

The installed equipment of every liferaft is listed in the following table:

Table 2: List of the Equipment of the Liferaft

No.	Name	Unit	Quantity	Comments
1	Fabric Bailer	Pc	1	For taking out water from the liferaft interior
2	Sea-anchor	Pc	1	To prevent liferaft from drifting out of the search area
3	Pump	Pc	1	To restore the pressure of the chamber if it is low
4	Safety Knife	Pc	1	To cut painter line
5	Owner's Manual	Book	1	Contains: Instructions, Log book, Immediate actions
6	Water activated Locator Light	Pc	1	Lights automatically when it comes in touch with water
7	Topping off valve	Pc	1	Used to fit the pump and restore pressure or to deflate the liferaft

6. Advice on the transportation and the storage of the liferaft

6.1 Transportation of the liferaft:

- When transporting or moving the liferaft use only the handle on the top of the valise.
- When placing it down on surfaces put it with special care.

6.2 Storage of the liferaft:

- Before putting the liferaft in its location read the owner's manual. Keep the manual in a safe position.
- The liferaft must always be located in a dry place, without obstacles
- Do not put weights or any metallic items in the main body of the liferaft.
- It is always necessary to follow the regulations that are obliged about the installation of the rescue means on board.
- The liferaft should never be used as a step or as a seat.
- The liferaft should never be attached using chains or any device which is difficult to be separated.
- You should install more liferafts on the same boat. If so, the liferafts must be located with a certain distance one to the other.
- It must be stowed in such a way that would not suffer any collisions and would be protected against any factors by the environment elements.
- If the liferaft has major damages on the valise, you should contact a LALIZAS authorized Service Station.
- There is a possibility that some of the standard fittings of the liferaft may affect the performance of a compass, so you should keep the liferaft at least one meter away from the compass.
- Grease, oil, fuel and various impurities may damage the fabric and affect the lifetime and operation of the liferaft.

7. Maintenance and servicing of the liferaft

Advice on the servicing of the liferaft

The liferaft should be inspected and serviced at intervals not longer than three years. In case of activation, or existence of damages, service it immediately. The inspection and service must be performed by a LALIZAS authorized Service Station. LALIZAS S.A. is not liable for any inspection or service carried out by an unauthorized Service Station.

For more information on LALIZAS world network of Authorized Service Stations please refer to the following link: <http://www.LALIZAS.com/service.php>

8. Immediate Action Card

1. CUT THE PAINTER LINE AND GET CLEAR OF THE VESSEL
2. CHECK RAFT FOR PROPER INFLATION. RAFT TUBE SHOULD BE FIRM
3. LOOK FOR AND PICK UP OTHER SURVIVORS
4. PICK UP ANY FLOATING EQUIPMENT
5. ENSURE SEA-ANCHOR STREAMED WHEN CLEAR OF VESSEL
6. SIT LOW ON THE FLOOR WITH YOUR BACK TOWARDS THE TUBE
7. BAIL OUT ANY WATER THAT HAS ENTERED THE RAFT
8. ACTIVATE ANY EMERGENCY RADIO BEACONS, IF AVAILABLE
9. SET-UP CANOPY (IF EQUIPPED)
10. CLOSE UP ENTRANCE
11. MAKE A CALM ESTIMATION OF YOUR SITUATION
12. KEEP CALM. DO NOT MOVE UNLESS NECESSARY

Important Note: Make sure that all the parts of the liferaft are inflated. If the tube of the liferaft is deflated, you should restore the pressure by using the pump of the standard equipment of the liferaft. The pressure relief valve is usually located inside the liferaft. If there is a leak of the inflation gas, the raft must be ventilated using the canopy opening.

Water: Eliminate the water that had entered the liferaft using the bailer of the standard equipment of the liferaft

9. LOG BOOK

Instructions on how to keep the log book

- A. The log book of a liferaft should always follow the liferaft in all its successive assignments.
- B. The liferaft should be equipped with the same accessories and materials when it is delivered and during its successive assignments afterward.
- C. The liferaft should be inspected & serviced periodically, which must be done only by Service Stations authorized by LALIZAS. LALIZAS is not liable for any inspection and service carried out by an unauthorized Service Station.
- D. In case of loss, theft, or change of names of the assigned ship, a new copy of this manual must be requested from LALIZAS S.A who will send it against payment.

I. Specifications

Type: LEISURE-RAFT

Rated Capacity: _____

Serial No: _____

Manufacturing Date: _____

Painter Line Length: _____

Stowage Height: _____

II. Inflation System

Certificate No. of Gas Cylinder: _____

Cylinder Serial No.: _____

Cylinder Working Pressure: _____

Empty Cylinder Weight: _____

CO₂ Weight: _____

Tolerance of CO₂: _____

Total Weight of Gas Cylinder (excluding operating head): _____

Operating Head Type: _____

Pressure Relief Valve Type: _____

Non-return Inlet Valve Type: _____

Topping off Valve Type: _____

III. Regular Check Records

Shipping Information	
Ship's Name:	
Port of Registry:	
Gas Cylinder Check	
Empty Gas Cylinder Weight:	Gas cylinder Serial No.
Gas Weight (CO2):	
Weight of Gas and Gas Cylinder:	
Total Weight:	
Notes: Before gas cylinder is installed, check the weight of the cylinder and confirm that it conforms that on the marking. If the reduction exceeds 2% of the stipulated weight or exceeds 100g (take the smaller value of the two), the gas cylinder is unqualified.	
Liferaft Body Check	
Liferaft body checking	Parts replacement
Service Conclusion:	
Service Record No.:	
Signature and Seal of Service Station:	

Shipping Information	
Ship's Name:	
Port of Registry:	
Gas Cylinder Check	
Empty Gas Cylinder Weight:	Gas cylinder Serial No.
Gas Weight (CO2):	
Weight of Gas and Gas Cylinder:	
Total Weight:	
Notes: Before gas cylinder is installed, check the weight of the cylinder and confirm that it conforms that on the marking. If the reduction exceeds 2% of the stipulated weight or exceeds 100g (take the smaller value of the two), the gas cylinder is unqualified.	
Liferaft Body Check	
Liferaft body checking	Parts replacement
Service Conclusion:	
Service Record No.:	
Signature and Seal of Service Station:	

Shipping Information	
Ship's Name:	
Port of Registry:	
Gas Cylinder Check	
Empty Gas Cylinder Weight:	Gas cylinder Serial No.
Gas Weight (CO2):	
Weight of Gas and Gas Cylinder:	
Total Weight:	
Notes: Before gas cylinder is installed, check the weight of the cylinder and confirm that it conforms that on the marking. If the reduction exceeds 2% of the stipulated weight or exceeds 100g (take the smaller value of the two), the gas cylinder is unqualified.	
Liferaft Body Check	
Liferaft body checking	Parts replacement
Service Conclusion:	
Service Record No.:	
Signature and Seal of Service Station:	

Shipping Information	
Ship's Name:	
Port of Registry:	
Gas Cylinder Check	
Empty Gas Cylinder Weight:	Gas cylinder Serial No.
Gas Weight (CO2):	
Weight of Gas and Gas Cylinder:	
Total Weight:	
Notes: Before gas cylinder is installed, check the weight of the cylinder and confirm that it conforms that on the marking. If the reduction exceeds 2% of the stipulated weight or exceeds 100g (take the smaller value of the two), the gas cylinder is unqualified.	
Liferaft Body Check	
Liferaft body checking	Parts replacement
Service Conclusion:	
Service Record No.:	
Signature and Seal of Service Station:	